

Shapwick Place, Ingleby Barwick

TS17 5NF



£179,950

- Built to the popular 'Souter' design
- Three double bedrooms, 'Master' with ensuite
- Accommodation over three impressive levels
- Attractive, westerly rear garden and front parking
- Favoured 'Rings' location

Home, Changes Everything





Built to the very popular 'Souter' design by Persimmon Homes, a style that delivers three impressively generous double bedrooms, the top floor 'Master' with ensuite.



Situated within the popular 'Rings' area of Ingleby Barwick, close to 'highly thought of' schooling and fantastic amenities, whilst enjoying a lovely, westerly rear garden, and one allocated parking bay ahead, with additional visitor spaces available.



Briefly, the attractive accommodation comprises an entrance hall, lounge, inner hall, cloakroom/WC and modern kitchen/.diner to the ground floor. The first floor brings two of the double bedrooms, along with the family bathroom. The second floor is occupied by the 'Master' bedroom, with a modern ensuite.

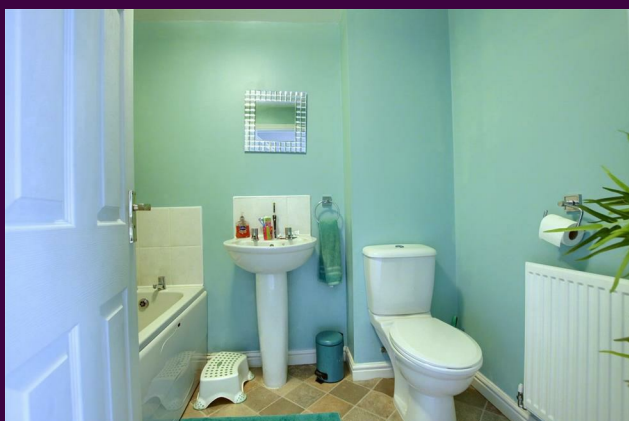

The rear garden is fully fence enclosed, with near-end patio and lawn, enjoying a sunny, westerly facing aspect.

The Layout

GROUND FLOOR

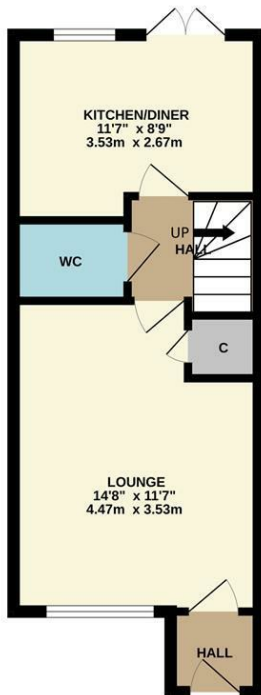

1ST FLOOR

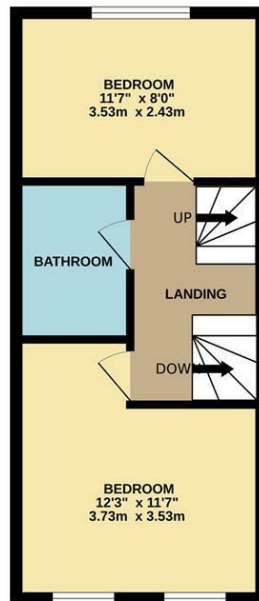

2ND FLOOR

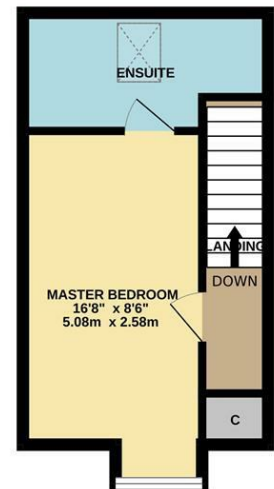

Whilst every attempt has been made to ensure the accuracy of the floorplan contained here, measurements of doors, windows, rooms and any other items are approximate and no responsibility is taken for any error, omission or mis-statement. This plan is for illustrative purposes only and should be used as such by any prospective purchaser. The services, systems and appliances shown have not been tested and no guarantee as to their operability or efficiency can be given.
Made with Metropix ©2025

The Location

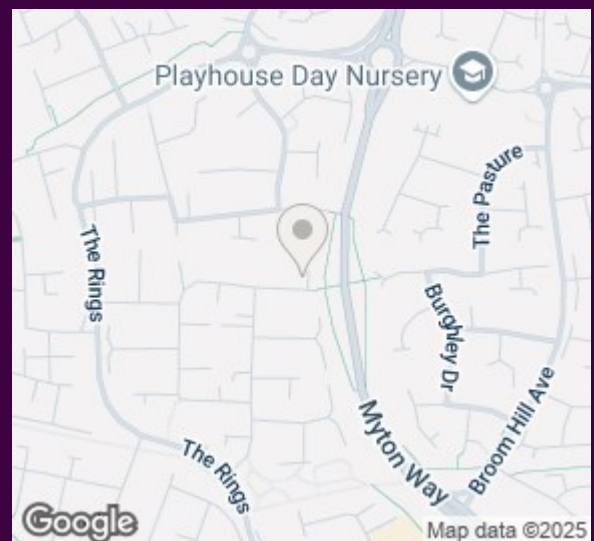

Home, Changes Everything



Shapwick Place

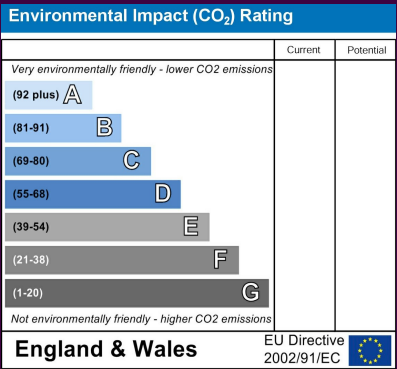
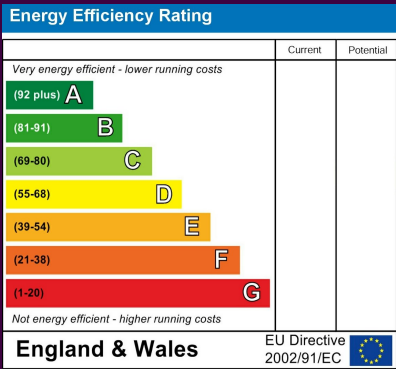

Council Tax Band: C
Tenure: Freehold

www.ingleby-homes.co.uk

Tel: 01642 671025

Email: sales@ingleby-homes.co.uk